

SPRAT 1 - STAN 13A

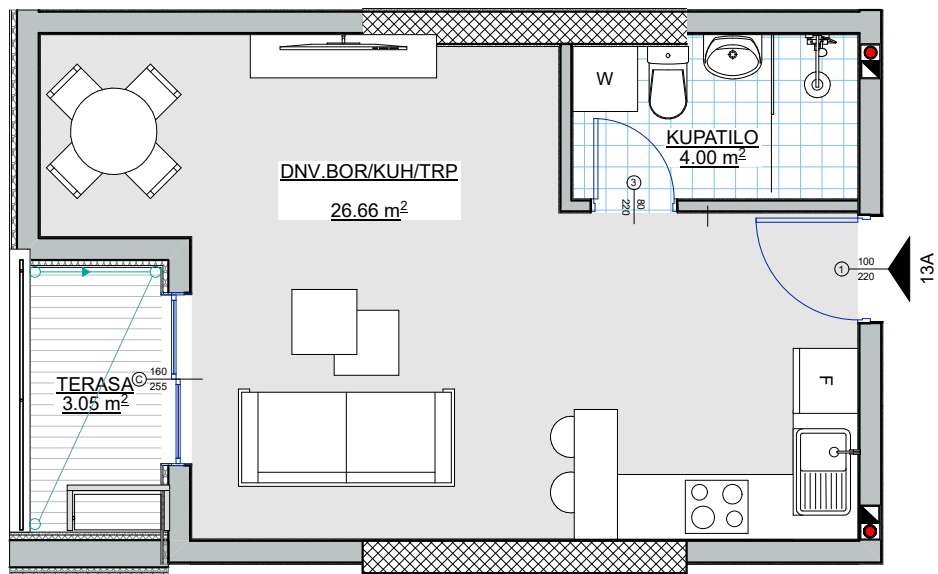

STAN 13A (garsonjera)

1.	DNE.BOR./KUH./TRP.	PARKET	JUPOL	JUPOL	26.66
2.	KUPATILO	KER.PLOCICE	SPUSTENI PLAFON	KER.PLOCICE	4.00
3.	TERASA	KER.PLOCICE			3.05
NETO POVRšina STANA 13A					33.71